

ELKAY[®]



EDUCATION PRODUCT PORTFOLIO

Drinking solutions for schools.



TOP OF THE CLASS

Elkay® sets the standard in schools by providing them with solutions that put fresh, filtered water within reach. Our range of commercial-grade products supports all of your education facility's plumbing needs—so you get a complete solution from the name you trust.



HYGIENIC FEATURES

Hands-free water delivery options and antimicrobial materials prevent the spread of germs.



SUSTAINABLE DESIGN

Eco-friendly drinking solutions are made from recycled and recyclable materials, and are approved by BREEAM, the leading product energy efficiency authority.



FILTERED SOLUTIONS

Filtered bottle filling stations and fountains provide cleaner, healthier drinking water.



ACCESSIBLE FOR ALL

Compliant with the Americans with Disabilities Act, the gold standard to accommodate physically disabled or visually impaired users.

*ADA compliant when properly installed.



GREEN OPERATION

Select drinking solutions reduce energy usage and plastic waste to keep schools green.



VANDAL RESISTANT

Tamper-resistant features withstand heavy use and defend against abuse.

Shown on cover

Top: LZSTL8WSJOCX + LZWSRJO Bottle Filler Station & Coolers; Bottom Left: LZSTL8WSL2K Bottle Filler Station; Bottom Right: LK4430BF1UEVG Bottle Filler Station



LZS8WSL2K



LZSTL8WSJOCX+LZWSRJO

WATER WHEREVER THEY NEED IT

Elkay has hydration solutions for every space.

Top Products

1

Hallways



VRCTL8WS2K

2

Gymnasium



LVRCTL8S2JOC

3

Outdoor



LK4400BFEVG

4

Cafeteria



LZS8WSJOX
+ LZWSRJJO

5

Break room



LZWSSMJO

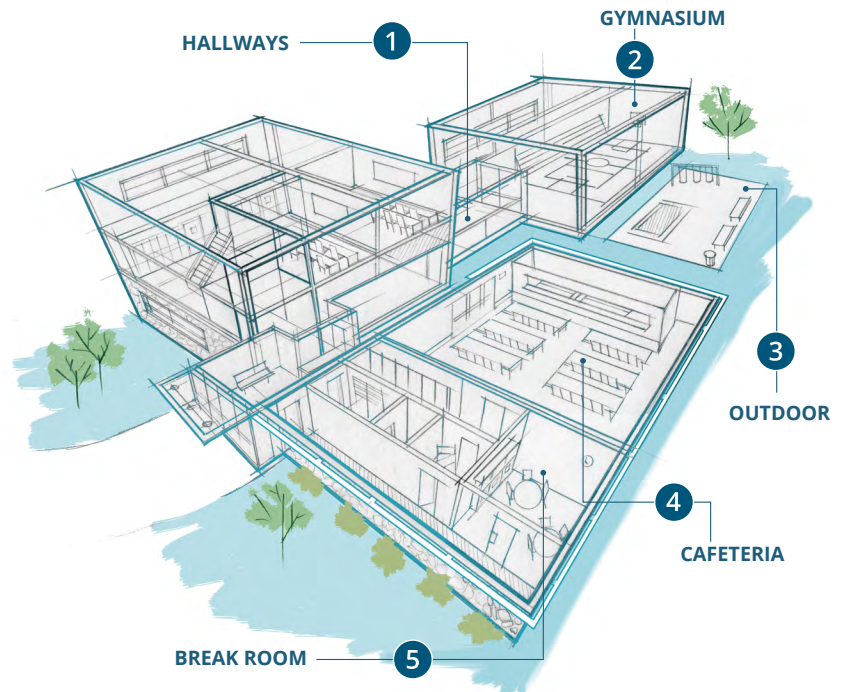

ELKAY'S DIFFERENTIATORS

- **Some of our units** include the Green Ticker™, a counter that informs users of the number of 500mL plastic water bottles saved from waste
- **The first manufacturer** to use refrigerants with an ozone-depletion potential (ODP) ratio of 0%
- **Our equipment** exceeds all energy-efficiency standards
- **Many components** made from recycled content, including stainless steel, galvanised steel, brass and corrugated cardboard (packing)
- **Product packaging** and the majority of our components are recyclable

DRINKING SOLUTIONS

Built for busy areas throughout school buildings, our trusted drinking solutions give students and staff access to cleaner, healthier water. Some of our filtration products are NSF International certified to reduce lead, chlorine and other contaminants - providing students and staff with fresh, filtered water to stay hydrated and focused.

BOTTLE FILLERS



LMASMB

Overall Size (LxWxD) 44.5cm x 15.2cm x 64.7cm
Chilling Option Non-refrigerated
Power 220V/50Hz
Activation Mechanical push button designed for use in limited wall depth applications, for areas where electricity is not available.
Features Antimicrobial, Filtered, Green Ticker, Laminar Flow, Real Drain, Visual Filter Monitor
ADA Compliant Yes
Global Compliance CE

[Learn More](#)



LZWSSMJO

Overall Size (LxWxD) 44.5cm x 20cm x 64.7cm
Chilling Option Non-refrigerated
Power 220V/50Hz
Activation Touchless, sensor-activated design for use in limited wall depth applications.
Features Antimicrobial, Filtered, Green Ticker, Hands Free, Laminar Flow, Real Drain, Visual Filter Monitor
ADA Compliant Yes

[Learn More](#)



LZWSM82K

Overall Size (LxWxD) 48.26cm x 7.6cm x 101.6cm
Chilling Option Sealed Refrigeration System
Power 220V/50Hz
Activation Touchless, sensor activation (bottle filler) designed for easy use.
Features Antimicrobial, Filtered, Green Ticker, Hands Free, Laminar Flow, Real Drain, Visual Filter Monitor
ADA Compliant Yes
Global Compliance CE

[Learn More](#)



LVRC8WS2K

Overall Size (LxWxD) 45.7cm x 48cm x 99cm
Chilling Option 30 LPH
Power 220V/50Hz
Activation Vandal-resistant, push-button activation for both the bottle filler and the water cooler.
Features Antimicrobial, Green Ticker, Laminar Flow, Real Drain
ADA Compliant Yes
Global Compliance CE

[Learn More](#)

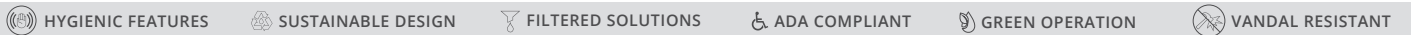

LZS8WSS2K

Overall Size (LxWxD) 44.5cm x 48cm x 99cm
Chilling Option Non-refrigerated
Power 220V/50Hz
Activation Touchless, sensor activation (bottle filler) designed for easy use; easy-to-operate push-bar activation (bubbler).
Features Antimicrobial, Filtered, Green Ticker, Hands Free, Laminar Flow, Real Drain, Visual Filter Monitor
ADA Compliant Yes
Global Compliance CE

[Learn More](#)



LZS8WSL2K

Overall Size (LxWxD) 44.5cm x 48cm x 99cm
Chilling Option Non-refrigerated
Power 220V/50Hz
Activation Touchless, sensor activation (bottle filler) designed for easy use; easy-to-operate push-bar activation (bubbler).
Features Antimicrobial, Filtered, Green Ticker, Hands Free, Laminar Flow, Real Drain, Visual Filter Monitor
ADA Compliant Yes
Global Compliance CE

[Learn More](#)



LZSTL8WSS2K

Overall Size (LxWxD) 92.5cm x 48cm x 99cm
Chilling Option Non-refrigerated
Power 220V/50Hz
Activation Touchless, sensor activation (bottle filler) designed for easy use; easy-to-operate push-bar activation (bubbler).
Features Antimicrobial, Filtered, Green Ticker, Hands Free, Laminar Flow, Real Drain, Visual Filter Monitor
ADA Compliant Yes
Global Compliance CE

[Learn More](#)



DRINKING SOLUTIONS

BOTTLE FILLERS



LZS8WSJOX + LZWSRJO



Overall Size (LxWxD)	46.5cm x 48cm x 99.5cm
Chilling Option	8.0 GPH
Power	220V/50Hz
Activation	Touchless, sensor activation designed for easy use.
Features	Hands Free, Optional Visual Filter Monitor, Green Ticker, Laminar Flow, Antimicrobial, Real Drain.
ADA Compliant	Yes

[Learn More](#)



LZSTL8WSJOCX + LZWSRJO



Overall Size (LxWxD)	93.5cm x 48cm x 99.5cm
Chilling Option	8.0 GPH
Power	220V/50Hz
Activation	Touchless, sensor activation (bottle filler bubbler) designed for easy use; easy-to-operate push-bar activation (bubbler).
Features	Hands Free, Optional Visual Filter Monitor, Green Ticker, Laminar Flow, Antimicrobial, Real Drain.
ADA Compliant	Yes

[Learn More](#)



LZSTL8WSJOCX + LZWSRJO



Overall Size (LxWxD)	93.5cm x 48cm x 99.5cm
Chilling Option	8.0 GPH
Power	220V/50Hz
Activation	Touchless, sensor activation (bottle filler bubbler) designed for easy use.
Features	Hands Free, Optional Visual Filter Monitor, Green Ticker, Laminar Flow, Antimicrobial, Real Drain.
ADA Compliant	Yes

[Learn More](#)



LRPBD28WSC + ENOBD8CX



Overall Size (LxWxD)	98cm x 48cm x 140.5cm
Chilling Option	8.0 GPH
Power	115V/60Hz (custom 220V model available)
Activation	Touchless, sensor activation (bottle filler) designed for easy use; easy-to-operate push-button activation (bubbler).
Features	Antimicrobial, Green Ticker, Hands Free, Laminar Flow, Real Drain
ADA Compliant	Yes

WATER WHEREVER THEY NEED IT

From bottle filling stations to water coolers and fountains, our drinking products offer the ultimate solution for your educational environment.



COOLERS AND FOUNTAINS



EDFP214C



Overall Size (LxWxD) 30.5cm x 47.5cm x 16.5cm
Chilling Option Non-refrigerated
Power No Electrical Required
Activation Mechanical push-button bubbler activation continues to provide water when electrical service is interrupted.
Features Flexi-Guard® Safety Bubbler
ADA Compliant Yes

[Learn More](#)



EDFP217C



Overall Size (LxWxD) 98cm x 49cm x 51.5cm
Chilling Option Non-refrigerated
Power No Electrical Required
Activation Mechanical push-button bubbler activation continues to provide water when electrical service is interrupted.
Features Flexi-Guard® Safety Bubbler
ADA Compliant Yes

[Learn More](#)



LVRC8S2JO



Overall Size (LxWxD) 46cm x 47.5cm x 52.5cm
Chilling Option 30 LPH
Power 220V/50Hz
Activation Mechanical push-button bubbler activation continues to provide water when electrical service is interrupted.
Features Filtered, Vandal Resistant
ADA Compliant Yes

[Learn More](#)









LVRCDS



Overall Size (LxWxD) 46cm x 47.5cm x 52.5cm
Chilling Option Non-refrigerated
Power No Electrical Required
Activation Mechanical push-button bubbler activation continues to provide water when electrical service is interrupted.
Features Filtered, Vandal Resistant
ADA Compliant Yes

[Learn More](#)

 HYGIENIC FEATURES
  SUSTAINABLE DESIGN
  FILTERED SOLUTIONS
  ADA COMPLIANT
  GREEN OPERATION
  VANDAL RESISTANT



LVRC8S2JOC



Overall Size (LxWxD) 92cm x 47.5cm x 69 cm
Chilling Option 30 LPH
Power 220V/50Hz
Activation Mechanical push-button bubbler activation
Features Filtered, Vandal Resistant
ADA Compliant Yes

[Learn More](#)



LZS8S2JO



Overall Size (LxWxD) 46.5cm x 48.5cm x 50.5cm
Chilling Option 30 LPH
Power 220V/50Hz
Activation Electronic bubbler push bars for easy activation
Features Filtered
ADA Compliant Yes

[Learn More](#)



LZS8L2JO



Overall Size (LxWxD) 46.5cm x 48.5cm x 50.5cm
Chilling Option 30 LPH
Power 220V/50Hz
Activation Electronic bubbler push bars for easy activation
Features Filtered
ADA Compliant Yes

[Learn More](#)



LZSTL8S2JOC



Overall Size (LxWxD) 93.5cm x 48.5cm x 64cm
Chilling Option Non-refrigerated
Power 220V/50Hz
Activation Electronic bubbler push bars for easy activation
Features Filtered
ADA Compliant Yes

[Learn More](#)

WATER WHEREVER THEY NEED IT

COOLERS AND FOUNTAINS



EFA8S2YJO



Overall Size (LxWxD) 45.5cm x 36.5cm x 105.5cm
Chilling Option 30 LPH
Power 220V/50Hz
Features Floor Mount/Freestanding, Flexi-Guard® Safety Bubbler
ADA Compliant No
Global Compliance CE

[Learn More](#)



LZO8S2JO



Overall Size (LxWxD) 46.5cm x 50.5cm x 50.5cm
Chilling Option 30 LPH
Power 220V/50Hz
Activation Touchless, sensor activation designed for easy use
Features Filtered, Hands Free, Visual Filter Monitor
ADA Compliant Yes

[Learn More](#)



ENOBM82QK



Overall Size (LxWxD) 50cm x 48.5cm x 103.5cm
Chilling Option 30 LPH
Power 240V/50Hz
Activation Touchless, sensor activation designed for easy use
Features Hands Free
ADA Compliant Yes

[Learn More](#)



EROM82K



Overall Size (LxWxD) 45cm x 47.5cm x 103.5cm
Chilling Option 30 LPH
Power 220V/50Hz
Activation Touchless, sensor activation designed for easy use
Features Hands Free, Flexi-Guard® Safety Bubbler
ADA Compliant Yes

[Learn More](#)

HYGIENIC FEATURES
 SUSTAINABLE DESIGN
 FILTERED SOLUTIONS
 ADA COMPLIANT
 GREEN OPERATION
 VANDAL RESISTANT



EFA8SP2YJO



Overall Size (LxWxD) 45.5cm x 36.5cm x 105.5cm
Chilling Option 8.0 GPH
Power 220V/50Hz
Activation Foot pedal activation
Features Floor Mount/Freestanding
ADA Compliant Yes
Global Compliance CE

[Learn More](#)



LZSTL8S2JOCX



Overall Size (LxWxD) 93.5cm x 48.5cm x 64cm
Chilling Option 30 LPH
Power 220V/50Hz
Activation Electronic bubbler push-button for easy activation
Features Wall mount, Flexi-Guard® Safety Bubbler, Hands Free
ADA Compliant Yes

[Learn More](#)

WATER WHEREVER THEY NEED IT

OUTDOOR



LK4420BF1U



Overall Size (LxWxD) 35.5cm x 78.74cm x 162.5cm
 Chilling Option Non-refrigerated
 Power No Electrical Required
 Activation Mechanical Bottle Filler Button With Mechanical Front Bubbler Button
 Features 316 Stainless, Heavy Duty Vandal Resistant, Laminar Flow
 ADA Compliant Yes

[Learn More](#)



LK4400BF



Overall Size (LxWxD) 35.5cm x 35.5cm x 162.5cm
 Chilling Option Non-refrigerated
 Power No Electrical Required
 Activation Mechanical Bottle Filler Button With Mechanical Front Bubbler Button
 Features 316 Stainless, Heavy Duty Vandal Resistant, Laminar Flow
 ADA Compliant Yes

[Learn More](#)

ACCESORIES



ER192

Elkay Remote Chiller Non-Filtered 19 GPH 220V

Special Note: Remote water chillers convert standard drinking fountains into a water cooler.

Global Compliance CE

[Learn More](#)



ECH82

Elkay Remote Chiller Non-Filtered 8 GPH 220V

Special Note: Remote water chillers convert standard drinking fountains into a water cooler.

Global Compliance CE

[Learn More](#)

AVAILABLE IN 12 STUNNING FINISHES

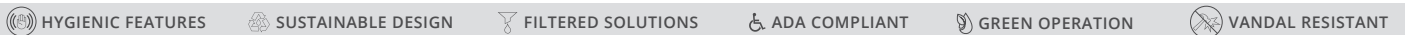

FILTRATION



51300C

Elkay WaterSentry Plus Replacement Filter (Bottle Fillers)

Special Note: eplacement filter for use in ezH2O bottle filling stations and with EWF3000 WaterSentry Plus systems.

[Learn More](#)



WSP35000

Elkay WaterSentry 35000 Gallon Bacteria Water Filtration System

Overall Size (LxWxD) 28cm x 14.2cm x 47.7cm

Special Note: This ultrafiltration system has a process that reduces particles and microorganisms of up to .2 microns. It also reduces odor, taste and chlorine.

[Learn More](#)

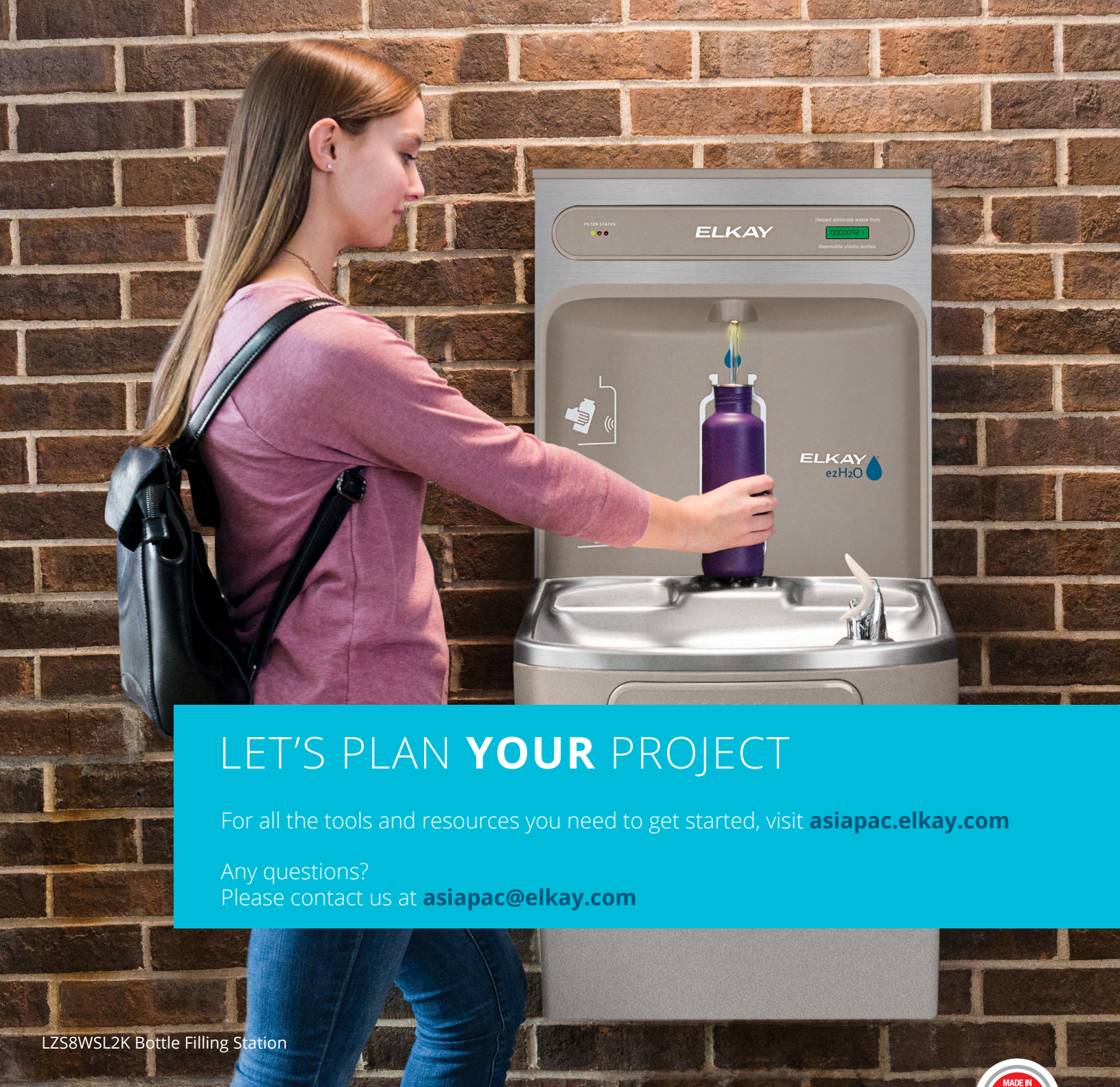

LET'S PLAN **YOUR** PROJECT

For all the tools and resources you need to get started, visit asiapac.elkay.com

Any questions?
Please contact us at asiapac@elkay.com

LZS8WSL2K Bottle Filling Station

Certifications

We continuously test our products to high internal standards. Many of our products are tested and certified to one or more of the following independent certifications. Check individual product listings for more information.



Built in the USA

100 years strong, Elkay has been using premium materials to build sinks and drinking solutions in the United States.